

Sea

the Possibilities
with
Portside Suites
Capital Campaign

Building Acquisition,
Renovation &
Expansion Project



2645 Ridge Road
Highland, IN 46322
219.961.4357
FairHavenRCC.org
kelly@FairHavenRCC.org



Introduction

Fair Haven Rape Crisis Center was founded in 2005 with just one program, two volunteers, \$500 and a whole lot of faith! Today, we serve Northwest Indiana as the only designated Rape Crisis Center. Fair Haven advocates serve as the continuum of care within a very complicated system. Victim advocates are the only discipline who walk alongside the survivor throughout the entire process.

In 2023, Fair Haven has served:

498 victims/survivors and provided 7,911 services

including Individual Counseling, Medical Advocacy/Accompaniment to Forensic Exam, Pediatric Exam Accompaniment, Crisis Line Advocacy, Safety Planning, Trauma Therapy, Crisis Intervention, Law Enforcement Interview Advocacy/Accompaniment, Judicial Advocacy, Financial Assistance, Transportation Assistance, Case Management, Language Services, Secondary Services and Animal Therapy.

In **2021**, Fair Haven provided **4,993 services (a 56% increase from 2020) to 316 victims** who identified with some form of sexual victimization and/or intimate partner violence.

In **2022**, Fair Haven served **469 victims/survivors (a 48.41% increase in victims served from 2021) and provided 9,103 services (a 105% increase in services from 2021).**

Looking Ahead

- With the **Acquisition** (Phase #1) of our current rented office building located in Highland, IN, we will continue to house the Rape Crisis Center operations and community services.
- **Renovation** of the current facility (Phase #2) will consist of a new entrance off the west side of the building, security system, along with cosmetic upgrades.
- **Expansion** (Phase #3) will add four secure non-congregate housing units for adults who are fleeing or attempting to flee from dating violence, sexual assault, stalking or human trafficking.



Sea the Possibilities

The need to provide 24/7/365 services is one of the most vital and immediate concerns for survivors of sexual violence, intimate partner violence, domestic violence and trafficking. Survivors often struggle with breaking the cycle and require secure housing that will allow them the time and space to decompress and heal.

Our plan includes essential wrap-around services and therapeutic counseling to learn healthy coping skills and unlearn abusive tactics. Victims may also need assistance with separation, divorce, child custody and support, guardianship, adoption, or emancipation.

The Fair Haven team is the go-to provider for Northwest Indiana victim-centered, trauma-informed services for victims of sex crimes including human trafficking.

Can you imagine the potential? When you invest in local programs, together we create a safe port in the storm!

“

A
Beacon
of Hope



”



Funding Already Secured

The estimated budget for the full building acquisition, renovation and expansion project = \$2,200,000.00. We are excited to announce that **\$1,826,850.00 dollars has already been secured!**

\$750,000.00

from the Economic Development Initiative (EDI) Funding with the help of Congressman Frank Mrvan

\$1,075,000.00

from the HOME Investment Partnerships American Rescue Plan (ARP) Program funding through Lake County Community Economic Development

\$1,850.00

Community Donations

“We can’t control the winds, but we can adjust our sails.”

\$373,150.00 Left to Raise

We are seeking Community Allies to partner with us to supply the remaining \$373,150.00 and ensure our project is fully funded. Allies will choose how to implement their gift over a 3-year period and name plates will live inside each space for the length of the gift. Below are crucial areas we need to develop within the current building space.

Lantern Sponsorship:

The Parking Lot

A safe, well-lit parking lot shines a warm welcome. Our entry is a little set back, which serves our mission well. However, it needs repaving, striping and a slightly larger entrance with a sign. Includes company logo on name plate.

Total Commitment: \$80,000

The Helm Sponsorship:

New Entrance & Lobby

This will be the first room a victim sees when walking into the agency for services. 443.4 Sq. Ft. & furnishing. Includes company logo on name plate.

Total Commitment: \$30,000

Bow Sponsorship:

Community Room

Creating a space where the community with resources can come into our facility and offer valuable services to survivors. 622 Sq. Ft. & furnishings. Includes company logo on name plate.

Total Commitment: \$30,000

Seagull Sponsorship:

Child Care Room

We need a kid-friendly place where survivors’ children can play while their parent is here. 315.2 Sq. Ft. & furnishings. Includes company logo on name plate.

Total Commitment: \$30,000

Pelican Sponsorship:

Youth Services Room

Nearly 25% of the clients we serve are children 18 or under. A space dedicated for their support groups is critical. 320 Sq. Ft. & furnishings. Includes company logo on name plate.

Total Commitment: \$30,000

Current Building Lower Level

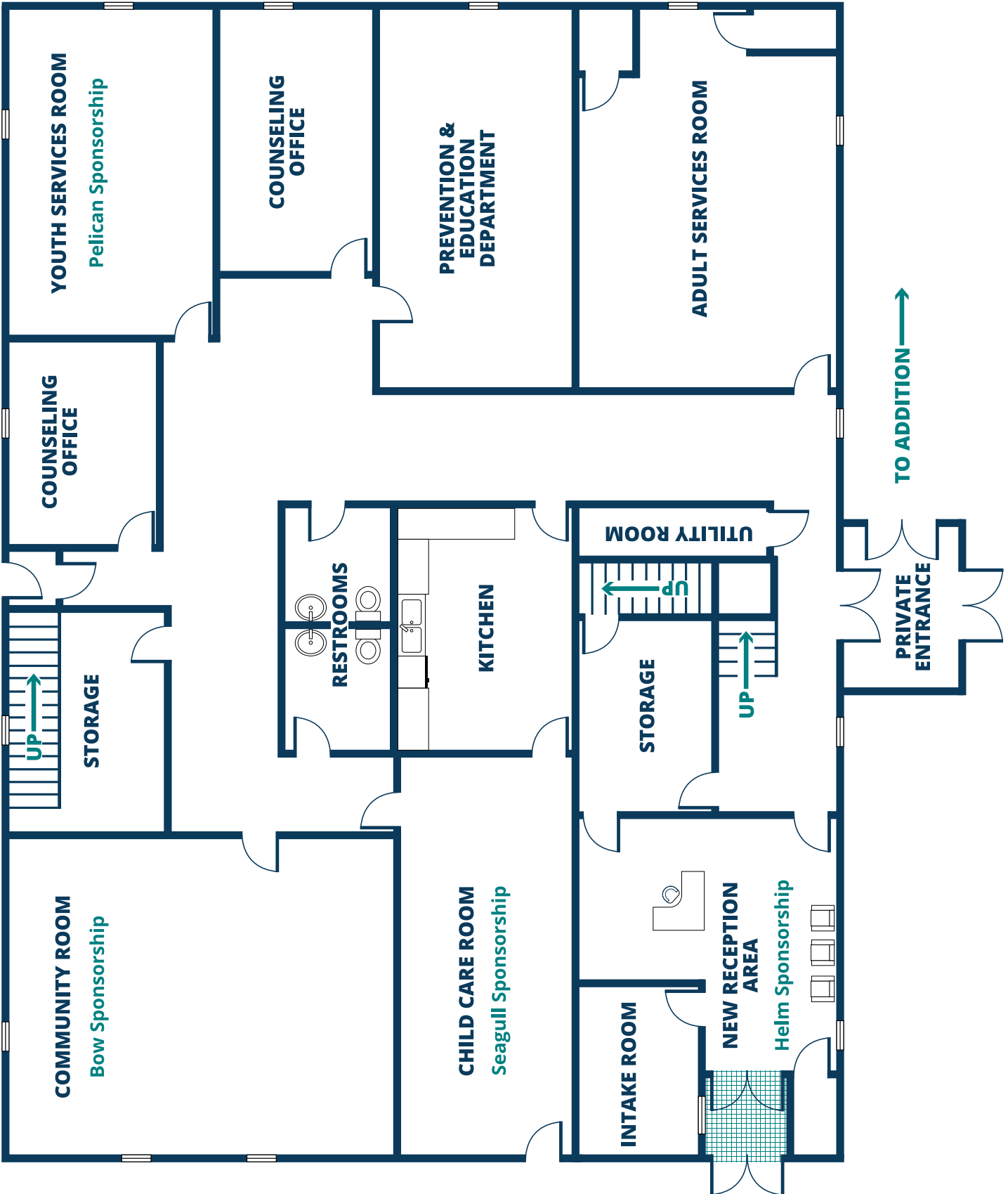

Portside Suites Ally

At Fair Haven, our MISSION is to serve survivors must remain our top priority! As we look beyond our current services, this mission has never been more important. The new building will be constructed on the east side of the property and will be **our expansion Phase #3** of the project.

How you leverage your God-given resources will have a profound and lasting impact in our community now and for years to come.

Star Board Sponsorship Suite #1

Located at the North end of the building, this is one of our large living quarters complete with a fully stocked galley kitchen, stackable laundry, private bath, closet, bedroom and living space with additional sleeping space available.

- 660 Sq. Ft. & furnishings
- Includes company logo on name plate located outside the front entrance
- **Total Commitment: \$45,750**

The Hull Sponsorship Suite #2

One of our standard living quarters located in the center of the building is complete with a fully stocked galley kitchen, stackable laundry, private bath, closet and living space.

- 525 Sq. Ft. & furnishings
- Includes company logo on name plate located outside the front entrance
- **Total Commitment: \$40,825**

The Hull Sponsorship Suite #3

One of our standard living quarters located in the center of the building is complete with a fully stocked galley kitchen, stackable laundry, private bath, closet and living space.

- 525 Sq. Ft. & furnishings
- Includes company logo on name plate located outside the front entrance
- **Total Commitment: \$40,825**

Portside Sponsorship Suite #4

Located at the South end of the building, this is one of our large living quarters, ADA compliant and complete with a fully stocked galley kitchen, stackable laundry, private bath, closet, bedroom and living space with additional sleeping space available.

- 660 Sq. Ft. & furnishings
- Includes company logo on name plate located outside the front entrance
- **Total Commitment: \$45,750**

Plans for Portside Suites

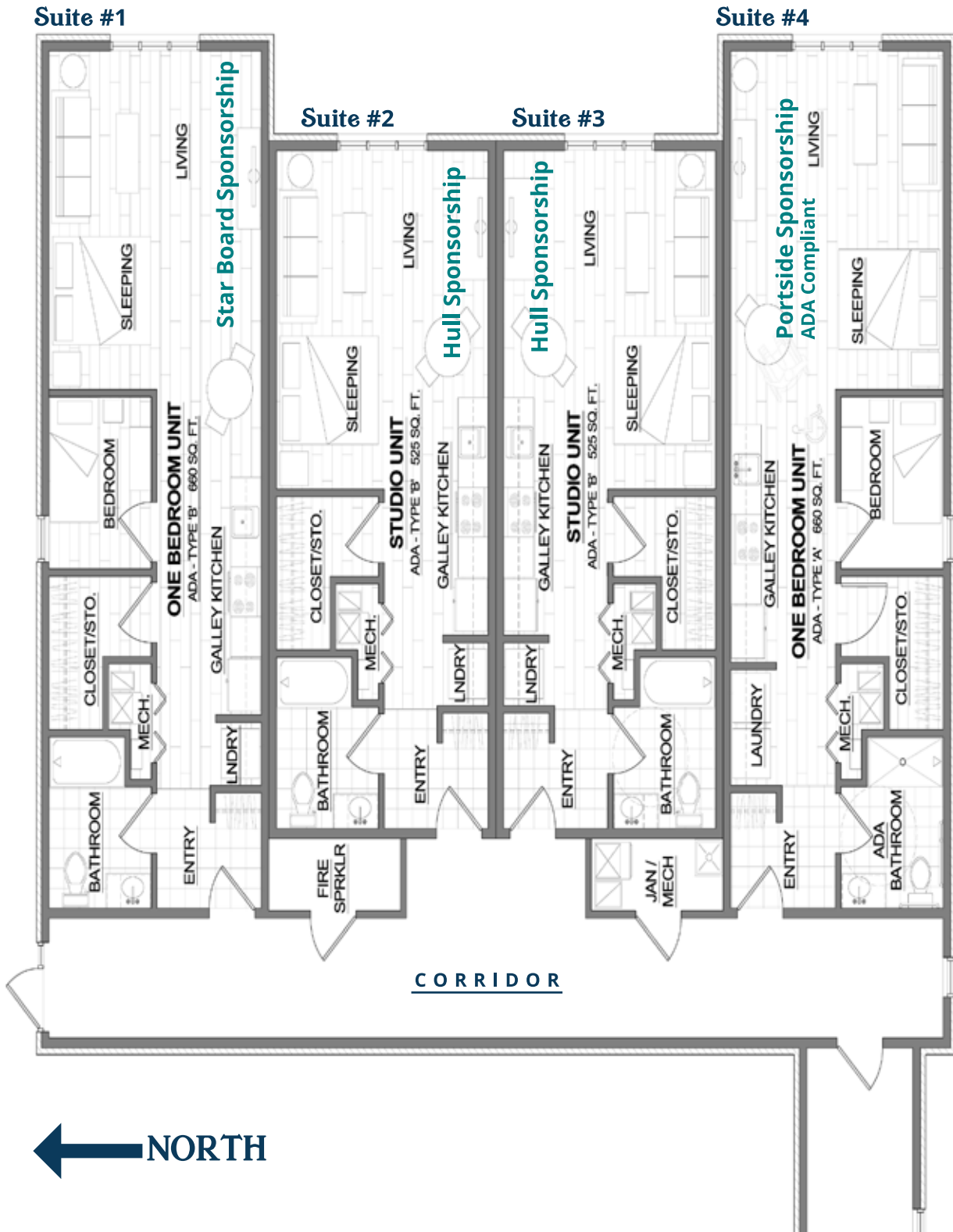



I pledge

to impact tomorrow
TODAY



Please complete this form and return it to
SHANA.ROBERTSON@FAIRHAVENRCC.ORG

Any size donation will make a difference



CONTACT NAME

COMMUNITY BUSINESS

PHONE

EMAIL

MAILING ADDRESS

	Description	Monthly	Quarterly	Annual	3 Year Total
<input type="checkbox"/>	Gale Wind Sponsor Create an Impact	\$500	\$1,500	\$6,000	\$18,000
<input type="checkbox"/>	Seagull Sponsor Child Care Room	\$834	\$2,500	\$10,000	\$30,000
<input type="checkbox"/>	Pelican Sponsor Youth Services Room	\$834	\$2,500	\$10,000	\$30,000
<input type="checkbox"/>	Helm Sponsor New Entrance	\$834	\$2,500	\$10,000	\$30,000
<input type="checkbox"/>	Lantern Sponsor Parking Lot	\$2,223	\$6,667	\$26,667	\$80,000
<input type="checkbox"/>	Bow Sponsor Community Room	\$834	\$2,500	\$10,000	\$30,000
<input type="checkbox"/>	Hull Sponsor Ste. 2 Portside Suite #2	\$1,135	\$3,402	\$13,608	\$40,825
<input type="checkbox"/>	Hull Sponsor Ste. 3 Portside Suite #3	\$1,135	\$3,402	\$13,608	\$40,825
<input type="checkbox"/>	Starboard Sponsor Portside Suite #1	\$1,270	\$3,814	\$15,250	\$45,750
<input type="checkbox"/>	Portside Sponsor Portside Suite #4	\$1,270	\$3,814	\$15,250	\$45,750

I PLEDGE TO GIVE:

\$ _____

- MONTHLY
 QUARTERLY
 YEARLY
 ONE-TIME GIFT

WAYS TO GIVE:

BY CHECK OR
ONLINE AT **FAIRHAVENRCC.ORG**